

PART NUMBER:
2HDLB - 1 9 * * - 1 2 3

SERIES ————— TAPE REEL PACKAGE

NO. OF POS. ————— SOLDER TAIL PLATING OPTION

CONTACT PLATED OPTION ————— BLANK: GOLD
 T: TIN

1: GOLD FLASH
 5: 5u" GOLD
 7: 15u" GOLD
 9: 30u" GOLD

HDMI TYPE D PIN ASSIGNMENT

PIN	Signal Assignment
1	Hot Plug Detect
2	Utility
3	TMDS Data2+
4	TMDS Data2 Shield
5	TMDS Data2-
6	TMDS Data1+
7	TMDS Data1 Shield
8	TMDS Data1-
9	TMDS Data0+
10	TMDS Data0 Shield
11	TMDS Data0-
12	TMDS Clock+
13	TMDS Clock Shield
14	TMDS Clock-
15	CEC
16	DDC/CEC Ground
17	SCL
18	SDA
19	+5V Power

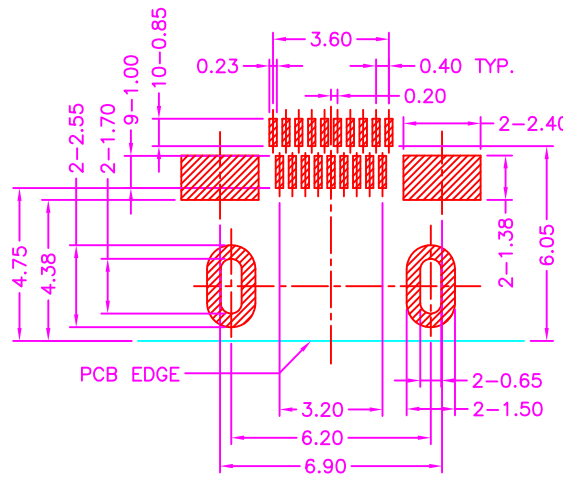
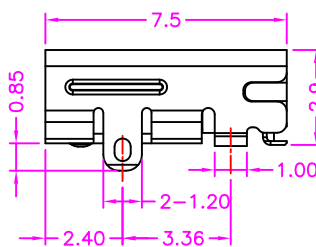
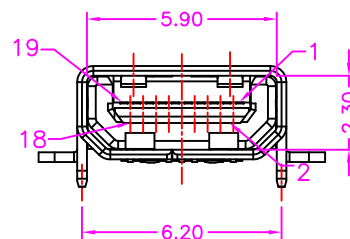

P.C.B LAYOUT
 TOP VIEW ±0.05

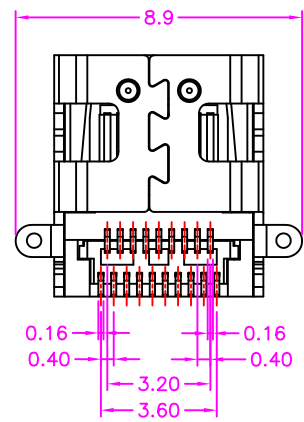

MATERIALS

HOUSING: HI-TEMP. PLASTIC (UL 94V-0)
 SHELL: COPPER ALLOY, NICKEL PLATING
 TERMINAL: COPPER ALLOY

SPECIFICATION

CURRENT RATING: 0.8 AMP MAX
 DIELECTRIC WITHSTANDING: 250V AC FOR ONE MINUTE
 CONTACT RESISTANCE: 10m OHMS MAX
 INSULATION RESISTANCE: 100M OHMS MIN AT DC 500V
 OPERATION TEMPERATURE: -30°C~+85°C

Cyberconn Technology Co., Ltd.
 www.cyberconn.com.tw Tel:+886-3-4951314

TOLERANCES	HDMI CONNECTOR SERIES				
X.X ±0.3	TITLE	MICRO HDMI, D TYPE, 0.40mm PITCH, PCB MOUNT, SMT, METAL SHIELD, FEMALE WITH EAR & MYLAR			
X.XX ±0.2	DRAWN BY	CHECKED BY	APPROVED BY		
X.XXX ±0.1	<i>Tina</i>	<i>Lion</i>	<i>Benson</i>		
Angle ±5°	UNIT	SCALE	SIZE	DRAW NO.	REV. Sheet
	10109	MM	NONE	A4	2HDLB-003 A 1/1

A	RELEASE	2014.8.28
REV.	DESCRIPTION	DATE