

**MATERIALS**

HOUSING: PBT (UL 94V-0)  
 SHELL: STEEL, NICKEL PLATING  
 LATCH: COPPER ALLOY  
 TERMINAL: COPPER, GOLD PLATED

**SPECIFICATION**

CURRENT RATING: 0.5 AMP MAX  
 DIELECTRIC WITHSTANDING: 1000V AC FOR ONE MINUTE  
 CONTACT RESISTANCE: 40m OHMS MAX  
 INSULATION RESISTANCE: 1000M OHMS MIN AT DC 500V  
 OPERATION TEMPERATURE: -55°C~+105°C

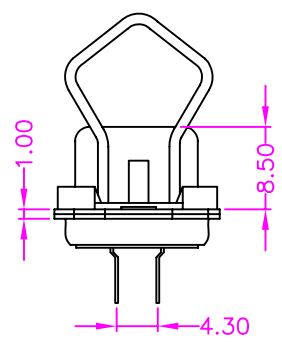
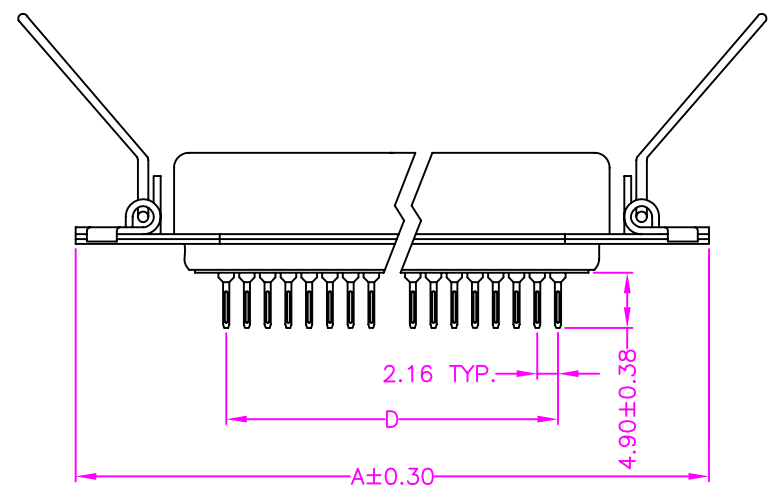

**PART NUMBER:**  
**2SCMD - 1 \* \* \* - 1 1 0**

SERIES ——— TRAY PACKAGE  
 PCB LAYOUT STYLE 1 ——— CONTACT PLATED OPTION  
 NO. OF POS. OPTION ——— 1: GOLD FLASH  
 REF. TABLE 1 ——— 3: 3u" GOLD  
 ——— 5: 5u" GOLD

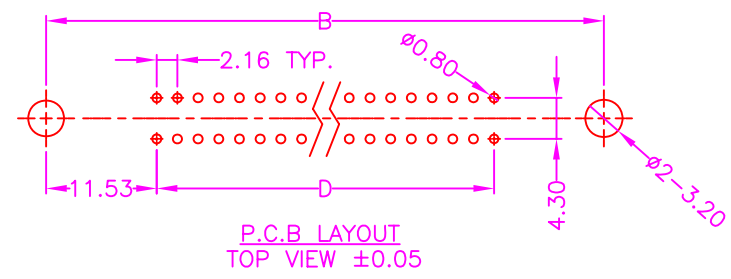

**TABLE 1**

| POS. | A    | B    | C    | D     |
|------|------|------|------|-------|
| 14   | 44.1 | 36.0 | 25.2 | 12.96 |
| 24   | 54.9 | 46.8 | 36.0 | 23.76 |
| 36   | 67.9 | 59.7 | 48.9 | 36.72 |
| 50   | 83.0 | 74.9 | 64.1 | 51.84 |

**Cyberconn Technology Co., Ltd.**  
 Tel.+886-3-4951314

| TOLERANCES |      | SCSI CONNECTOR SERIES   |             |               |           |      |       |
|------------|------|---|-------------|---------------|-----------|------|-------|
| X.X        | ±0.3 | TITLE CENTRONIC SCSI, STYLE 1, 2.16mm PITCH, PCB MOUNT, VERTICAL, METAL SHIELD, FEMALE, WITCH LATCH |             |               |           |      |       |
| X.XX       | ±0.2 |   |             |               |           |      |       |
| X.XXX      | ±0.1 |   |             |               |           |      |       |
| Angle ±5°  |      | DRAWN BY  | CHECKED BY  | APPROVED BY   |           |      |       |
|            |      | <i>Janice</i>   | <i>Lion</i> | <i>Benson</i> |           |      |       |
|            |      | UNIT  | SCALE       | SIZE          | DRAW NO.  | REV. | Sheet |
| 10044      |      | MM  | NONE        | A4            | 2SCMD-001 | A    | 1/1   |

| A    | RELEASE     | 2011.7.4 |
|------|-------------|----------|
| REV. | DESCRIPTION | DATE     |