

P.C.B. LAYOUT  
TOP VIEW ±0.05

PART NUMBER:  
4CEE<sup>B</sup> - 3 6 \* T - 1 1 0

SERIES NO. OF POS. TRAY PACKAGE

CONTACT PLATED OPTION TIN PLATING ON SOLDER TAIL

1: GOLD FLASH  
3: 3u" GOLD  
5: 5u" GOLD  
6: 10u" GOLD

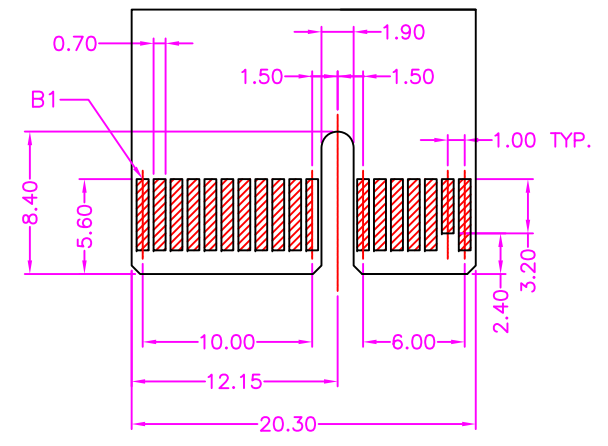
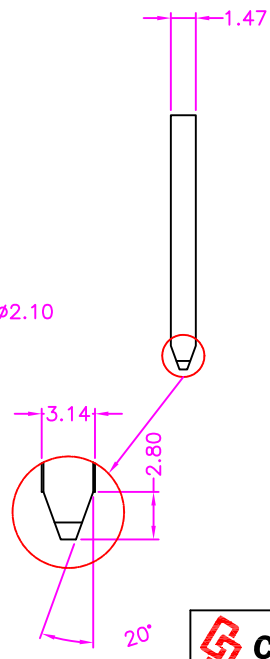
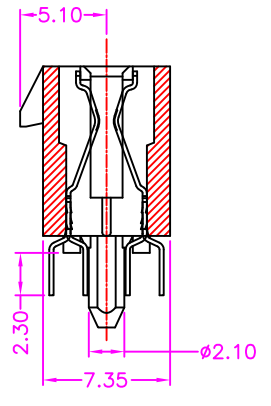
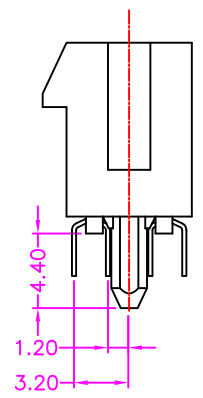

PRIMARY (COMPONENT) SIDE

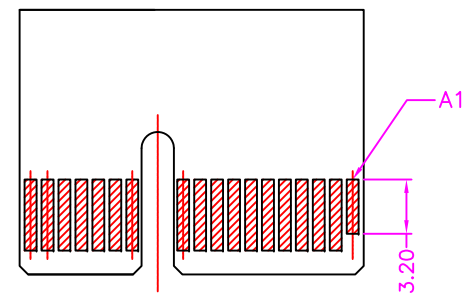

SECONDARY (SOLDER) SIDE

MATERIALS  
HOUSING: NYLON 66 (UL 94V-0), BLACK  
TERMINAL: COPPER ALLOY, GOLD PLATED ON CONTACT AREA  
TIN PLATING ON SOLDER TAIL

SPECIFICATION  
CURRENT RATING: 1.1 AMP MAX  
DIELECTRIC WITHSTANDING: 500V AC FOR ONE MINUTE  
CONTACT RESISTANCE: 30m OHMS MAX  
INSULATION RESISTANCE: 1000M OHMS MIN AT DC 500V  
OPERATION TEMPERATURE: -55°C~+105°C

**Cyberconn Technology Co., Ltd.**  
www.cyberconn.com.tw Tel:+886-3-4951314

TOLERANCES	CARD EDGE CONNECTOR SERIES				
X.X ±0.3 X.XX ±0.2 X.XXX ±0.1 Angle ±5°	TITLE	PCI EXPRESS, 36PIN, 1.00mm PITCH, PCB MOUNT, VERTICAL, FEMALE, 1 KEY			
	DRAWN BY	CHECKED BY	APPROVED BY		
	<i>Janice</i>	<i>Lion</i>	<i>Benson</i>		
UNIT	SCALE	SIZE	DRAW NO.	REV.	Sheet
10033	MM	NONE	A4	4CEE <sup>B</sup> -001	A 1/1

A	RELEASE	2011.9.16
REV.	DESCRIPTION	DATE